

Massachusetts Cultural Resource Information System

Scanned Record Cover Page

Inventory No:	BOS.8324
Historic Name:	Saint Gabriel's Monastery
Common Name:	Boston College Dormitory
Address:	159 Washington St
City/Town:	Boston
Village/Neighborhood:	Allston - Brighton; Brighton
Local No:	AB 515
Year Constructed:	
Architect(s):	Sheehan, T. Edward
Architectural Style(s):	Spanish Eclectic
Use(s):	Business Office; Classroom; Dormitory; Hospital; Monastery
Significance:	Architecture; Education; Health Medicine; Religion
Area(s):	BOS.KG: Washington - Warren Streets Institutional Area
Designation(s):	Local Landmark (1/25/1989); Preservation Restriction (6/23/2003)
Building Materials(s):	Roof: Ceramic Tile; Glazed Terra Cotta; Asphalt Shingle Wall: Stucco; Brick; Ceramic Tile; Glass Foundation: Stone, Cut



The Massachusetts Historical Commission (MHC) has converted this paper record to digital format as part of ongoing projects to scan records of the Inventory of Historic Assets of the Commonwealth and National Register of Historic Places nominations for Massachusetts. Efforts are ongoing and not all inventory or National Register records related to this resource may be available in digital format at this time.

The MACRIS database and scanned files are highly dynamic; new information is added daily and both database records and related scanned files may be updated as new information is incorporated into MHC files. Users should note that there may be a considerable lag time between the receipt of new or updated records by MHC and the appearance of related information in MACRIS. Users should also note that not all source materials for the MACRIS database are made available as scanned images. Users may consult the records, files and maps available in MHC's public research area at its offices at the State Archives Building, 220 Morrissey Boulevard, Boston, open M-F, 9-5.

Users of this digital material acknowledge that they have read and understood the MACRIS Information and Disclaimer (<http://mhc-macris.net/macrisdisclaimer.htm>)

Data available via the MACRIS web interface, and associated scanned files are for information purposes only. THE ACT OF CHECKING THIS DATABASE AND ASSOCIATED SCANNED FILES DOES NOT SUBSTITUTE FOR COMPLIANCE WITH APPLICABLE LOCAL, STATE OR FEDERAL LAWS AND REGULATIONS. IF YOU ARE REPRESENTING A DEVELOPER AND/OR A PROPOSED PROJECT THAT WILL REQUIRE A PERMIT, LICENSE OR FUNDING FROM ANY STATE OR FEDERAL AGENCY YOU MUST SUBMIT A PROJECT NOTIFICATION FORM TO MHC FOR MHC'S REVIEW AND COMMENT. You can obtain a copy of a PNF through the MHC web site (www.sec.state.ma.us/mhc) under the subject heading "MHC Forms."

Commonwealth of Massachusetts
Massachusetts Historical Commission
220 Morrissey Boulevard, Boston, Massachusetts 02125
www.sec.state.ma.us/mhc

This file was accessed on:

Monday, June 13, 2016 at 11:51 AM

FORM B – BUILDING

MASSACHUSETTS HISTORICAL COMMISSION
MASSACHUSETTS ARCHIVES BUILDING
2 MORRISSEY BOULEVARD
BOSTON, MASSACHUSETTS 02125

		K16	8324
--	--	-----	------

Town: ~~Brighton~~ Boston (Brighton)

Place (neighborhood or village): Brighton Center

ALLISON M. BROWN

Address: 159 Washington Street

*1125189-LL
6123103-PR*

Historic Name: St. Gabriel's Monastery

Uses: Present: St. Elizabeth's Foundation and Hospital offices

Original: Monastery for the Passionists, a Roman Catholic Religious Order

Date of Construction: 1909

Source: Corner stone

Style/Form: Mission

Architect/Builder: unknown

Exterior Materials:

Foundation: Stone

Wall/Trim: Stucco

Roof: Spanish tile

Outbuildings/Secondary Structures

Major Alterations (with dates)

Condition Fair

Moved no yes Date

Acreage: 14

Setting: Hospital campus and residential area.

Photograph



Sketch Map

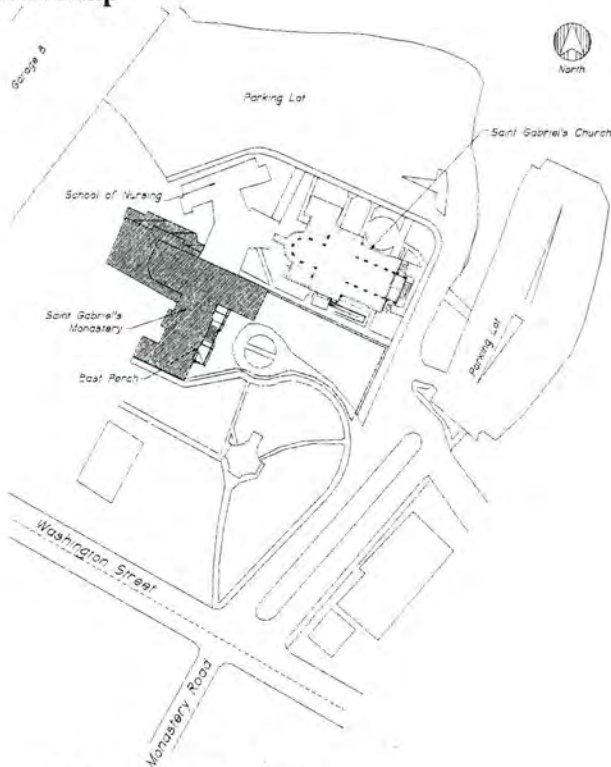

Recorded by: Kevin B. Cash

Organization: Simpson Gumpertz & Heger Inc.

Date: September 2003

Assessor's Number USGS Quad Area(s) Form Number

RECEIVED

SEP 30 2006

MASS. HIST. COMM

BUILDING FORM**A1 ARCHITECTURAL DESCRIPTION** *see continuation sheet*

St. Gabriel's Monastery is built in the Mission-style of architecture, including red tile roofs with wide overhangs, porches with square columns with arches between, shaped Mission dormers and parapets, corner towers, and stucco coating.

St. Gabriel's Monastery was approximately "T" in plan, along the north-south axis. The building is three-stories tall, built in various stages. One-story porches are located on the north and south elevations. The main and porch roofs are covered with red clay Spanish-type tile (the north porch roof is currently partially covered with asphalt shingles). A tower extends above the roof at the southeast corner of the building with shaped Mission parapets; other shaped Mission parapets extend above the roof in various areas. The walls of the monastery are stucco clad brick masonry, with a pinkish coating.

HISTORICAL NARRATIVE *see continuation sheet*

In 1907 the Passionists received permission to establish a monastery in Boston. Father Fidelis Kent Stone, husband, father and widower, former Episcopal minister, President of Kenyon and Hobart Colleges, convert, Paulist priest and Passionist, pioneered the effort. In 1908 the Nevins Estate in Brighton was purchased. Dedicated in 1911, St. Gabriel's Monastery, built with attention to Spanish architecture, was soon home to a small community of itinerant preachers and a public chapel where many came for spiritual consolation. St. Gabriel's also served as a Passionist house of studies. From 1911 to 1978, St. Gabriel's was home to a laymen's retreat movement. A separate retreat wing was added to the monastery in 1927 and expanded in 1950. In the post-conciliar era this ministry grew and changed from a monastic style retreat to a team approach.

In 1928 a church was built on the property to replace the chapel. Weekly devotions in honor of Passionists saints, an outreach to the community, especially the many hospitals and public housing developments, and an option for the poor with parish projects have been important ministries over the decades.

From 1970 until 1977, a portion of the monastery served as the first Passionist health care facility. In 1978 the Passionists decided to close St. Gabriel's Monastery due to financial concerns and lack of personnel. In 1980 it was sold to St. Elizabeth's Hospital. From the early 1980s until the late 1990s, a small Passionist community resided at St. Gabriel's Residence, adjacent to the original property.

In 1934 St. Gabriel's Parish was created, with offices in the monastery. In 1966 Our Lady of Fatima Shrine was built by the monastery community, but now the services are conducted by church and lay personnel. In 1967 a convent was completed for the parish school; however, by 1970 the school closed, the Sisters of St. Joseph moved, and the Passionist parish staff relocated in the convent. The school building has remained a vibrant site for alternative educational programs. In the 1970s a Spanish liturgy was initiated in the parish.

BIBLIOGRAPHY and/or REFERENCES *see continuation sheet*

The Passionist Historical Archives (website: www.cprovince.org), 526 Monastery Place, Union City, NJ 07087.

Recommended for listing in the National Register of Historic Places. *If checked, you must attach a completed National Register Criteria Statement form.*



LL-1/25/89 ON #8324 DMZ (KG)

BOSTON LANDMARKS COMMISSION

Building Information Form Form No. AB515

Area Allston/Brighton

#159

8324

ADDRESS Washington St COR. Fidelis Way

NAME St Gabriel's Passionist Monastery
present original

MAP No. 23N-5E SUB AREA Brighton

DATE 1909 Building Permit source

ARCHITECT T Edward Sheehan source

BUILDER not listed source CHURCH - 8325

OWNER Brothers of the Passionist Order
original present of the Roman Catholic Church

PHOTOGRAPHS AB 11 4/1, 4/2-78



TYPE (residential) single double row 2-fam. 3-deck ten apt.
(non-residential) religious institution

NO. OF STORIES (1st to cornice) 3 plus 1/2
mission tile

ROOF gable across w/sprung eaves cupola dormers 2 hipped along front facade

MATERIALS (Frame) clapboards shingles stucco asphalt asbestos alum/vinyl
(Other) brick stone concrete iron/steel/alum.

BRIEF DESCRIPTION Irregularly shaped mission style institutional building with 1-story arcaded front porch, central entrance marked by shaped gable, square 4-level corner towers w/ shaped gables

EXTERIOR ALTERATION (minor) moderate drastic

CONDITION (good) fair poor LOT AREA 607,880 (total monastery complex) sq. feet

NOTEWORTHY SITE CHARACTERISTICS Monastery has hill-top site with views of Boston-Cambridge, well-treed area with landscaping

SIGNIFICANCE (cont'd on reverse) Good

example of the mission style popular for Brighton religious institutions

(Map)

Moved; date if known _____

Themes (check as many as applicable)

Aboriginal	_____	Conservation	_____	Recreation	_____
Agricultural	_____	Education	_____	Religion	<u>X</u>
Architectural	<u>X</u>	Exploration/ settlement	_____	Science/ invention	_____
The Arts	_____	Industry	_____	Social/ humanitarian	_____
Commerce	_____	Military	_____	Transportation	_____
Communication	_____	Political	_____		
Community/ development	_____				

Significance (include explanation of themes checked above)



Preservation Consideration (accessibility, re-use possibilities, capacity for public use and enjoyment, protection, utilities, context)

Monastery closed Sept 1, 1978 because of decline in the number of priests & brothers in the Passionist Order. The mission-style monastery building is presently leased to Boston College for use as a dormitory. The adjacent St. Gabriel's church continues in use for religious services.

Bibliography and/or references (such as local histories, deeds, assessor's records, early maps, etc.)

Summer 1978

BOS. 8324, BOS. 8325, BOS. 8671
BOS. 8672, BOS. 8673, BOS. 8674

Community: BOSTON (BRIGHTON)

MHC OPINION: ELIGIBILITY FOR NATIONAL REGISTER

Date Received: Date Due: Date Reviewed: 1/4/89

Type: Individual District (Attach map indicating boundaries)

Name: ^(COMPLEX) St. Gabriel's Monastery Complex Inventory Form: see Landmark Study Report

Address: Washington St., Brighton

Requested by:

Action: Honor ITC Grant R & C Other:

Agency: Staff in charge of Review: MABC

INDIVIDUAL PROPERTIES

- Eligible
- Eligible, also in district
- Eligible only in district
- Ineligible
- More information needed

DISTRICTS

- Eligible
- Ineligible
- More information needed

CRITERIA: (A) B (C) D

LEVEL: Local State National

STATEMENT OF SIGNIFICANCE by Katherine Boonin

St. Gabriel's Monastery complex meets National Register criteria A and C for its association with the Passionist Order's history in the Boston area and as an example of ecclesiastical and institutional architecture.

The Monastery building (1909-1910) is a good example of the mission style, which was used infrequently in Boston. The church (1929) is by Maginnis and Walsh, an architecture firm noted for their designs of Roman Catholic churches. The retreat home (1927), although not in itself remarkable, serves to join these two buildings into a coherent whole through the use of compatible materials and design.

The landscape setting, designed in part by the Olmsted Bros., has suffered some loss of integrity, and probably does not constitute a significant historic designed landscape. However, it does contribute to the setting of the complex, and boundaries ~~stair~~ of the nomination should include the entire parcel. More information on the monastery path would determine if it too should be included with this complex.

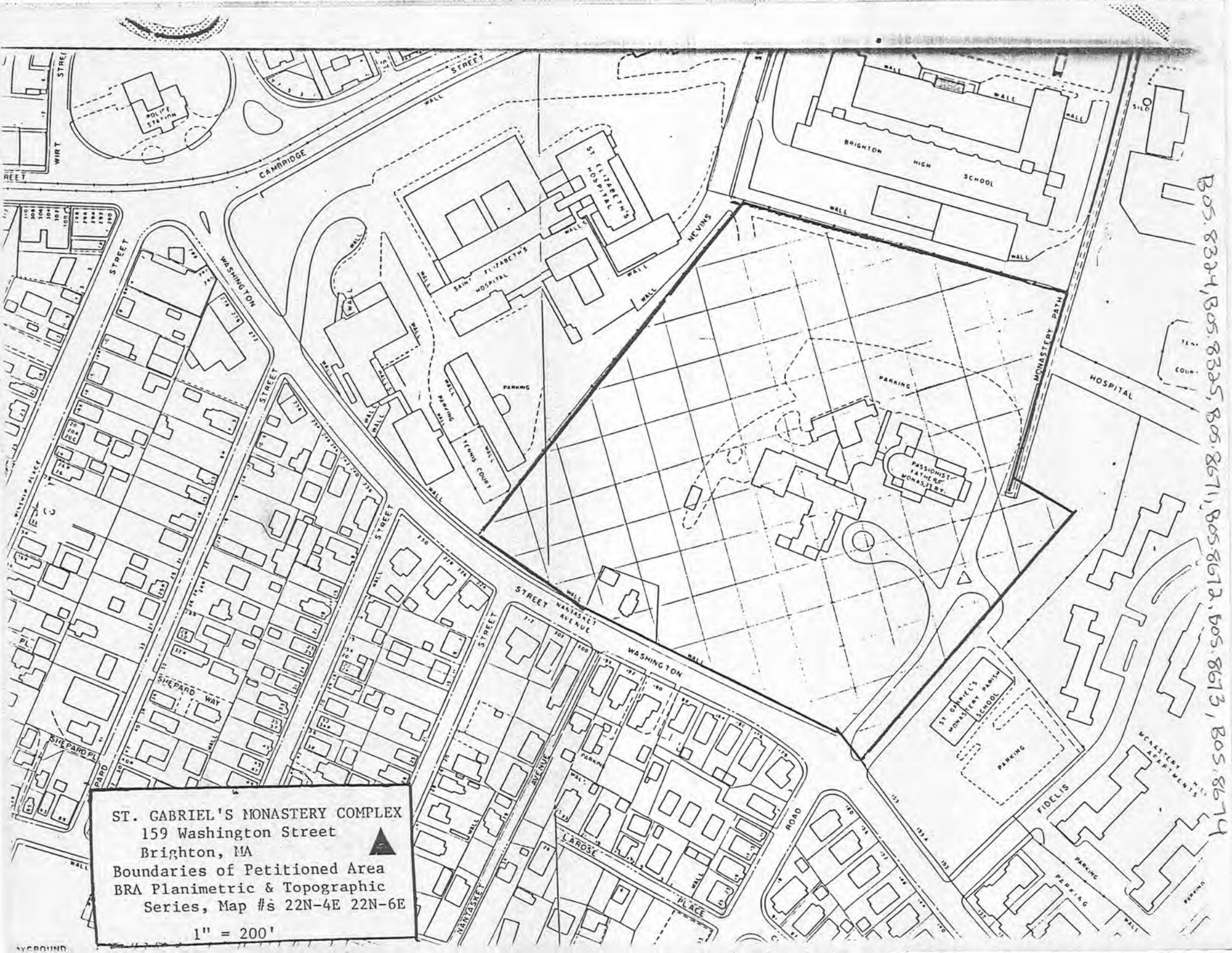

B05-8324, B05-8325, B05-8671, B05-8672, B05-8673, B05-8674

ST. GABRIEL'S MONASTERY COMPLEX
 159 Washington Street
 Brighton, MA ▲
 Boundaries of Petitioned Area
 BRA Planimetric & Topographic
 Series, Map #s 22N-4E 22N-6E
 1" = 200'